

SUITE 510

Work-Ready Loft

FLOOR: 5
AREA: 77,776 SF
7,226 M²

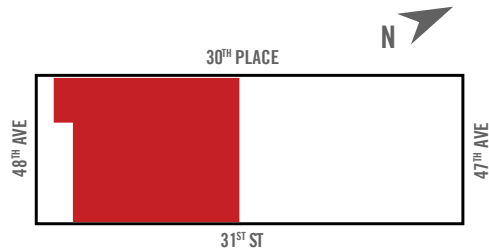

FEATURES:

- » AVAILABLE IN NOVEMBER 2024
- » EXCELLENT NATURAL LIGHT WITH CITY VIEWS AND NORTHERN AND EASTERN EXPOSURE
- » APPROX. 12' CEILINGS
- » APPROX. 22' COLUMN SPACING
- » DIRECT ACCESS TO MULTIPLE LOADING DOCKS AND FREIGHT ELEVATORS

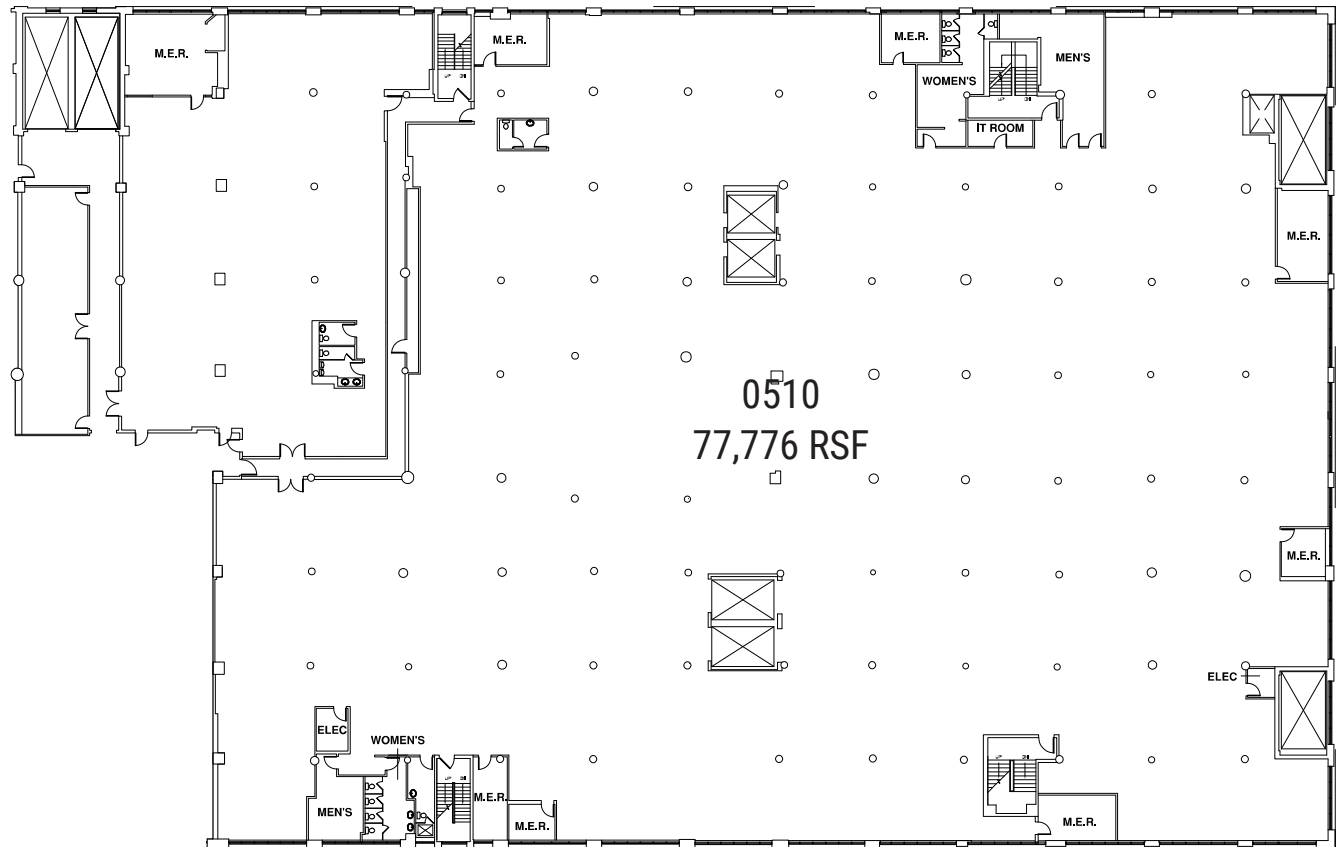

30-30 47th Avenue
Long Island City - NY, NY 11101

CONTACT:
212.372.2110

Howard J. Kessler Jr.
Howard.Kessler@nmrk.com

