

SUITE 460

Work-Ready Loft

FLOOR: 4 AREA: 6,307 SF
586 M²

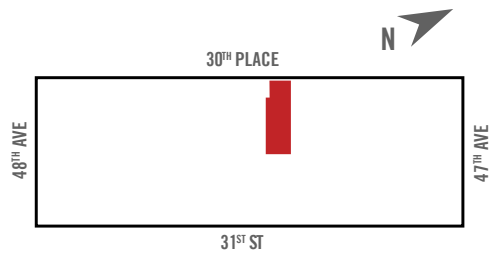

FEATURES:

- » PRE-BUILD IN EXCELLENT CONDITION
- » PHOTO STUDIO BUILD-OUT
- » APPROX. 12' CEILINGS
- » APPROX. 22' COLUMN SPACING

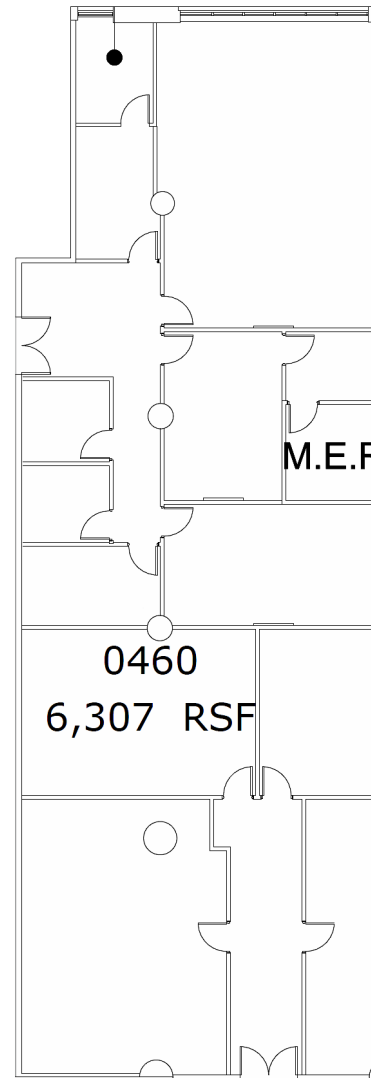

30-30 47th Avenue
Long Island City - NY, NY 11101

CONTACT:
212.372.2110

Howard J. Kessler Jr.
Howard.Kessler@nmrk.com

