

SUITE 414

Work-Ready Prebuild

FLOOR: AREA:
4 **16,102 SF**
1,495 M²

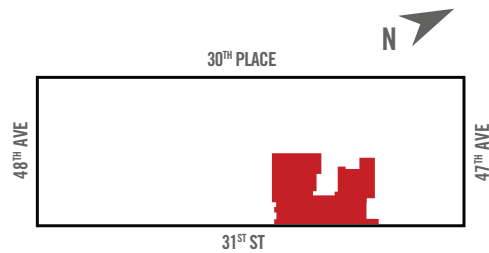

FEATURES:

- » WORK-READY LOFT SPACE
- » APPROX. 12' CEILINGS
- » INDOOR PARKING AVAILABLE
- » NEW FULLY FUNCTIONAL WINDOWS
- » TENANT CONTROLLED AC
- » 24H ACCESS AND SECURITY
- » FREIGHT ELEVATORS
- » SHUTTLE SERVICE TO SUBWAY & LIRR
- » RENOVATED LOBBY
- » NEW LOUNGE WITH VARIETY OF DINING OPTIONS
- » SECURE BIKE STORAGE
- » WIREScore GOLD CERTIFIED

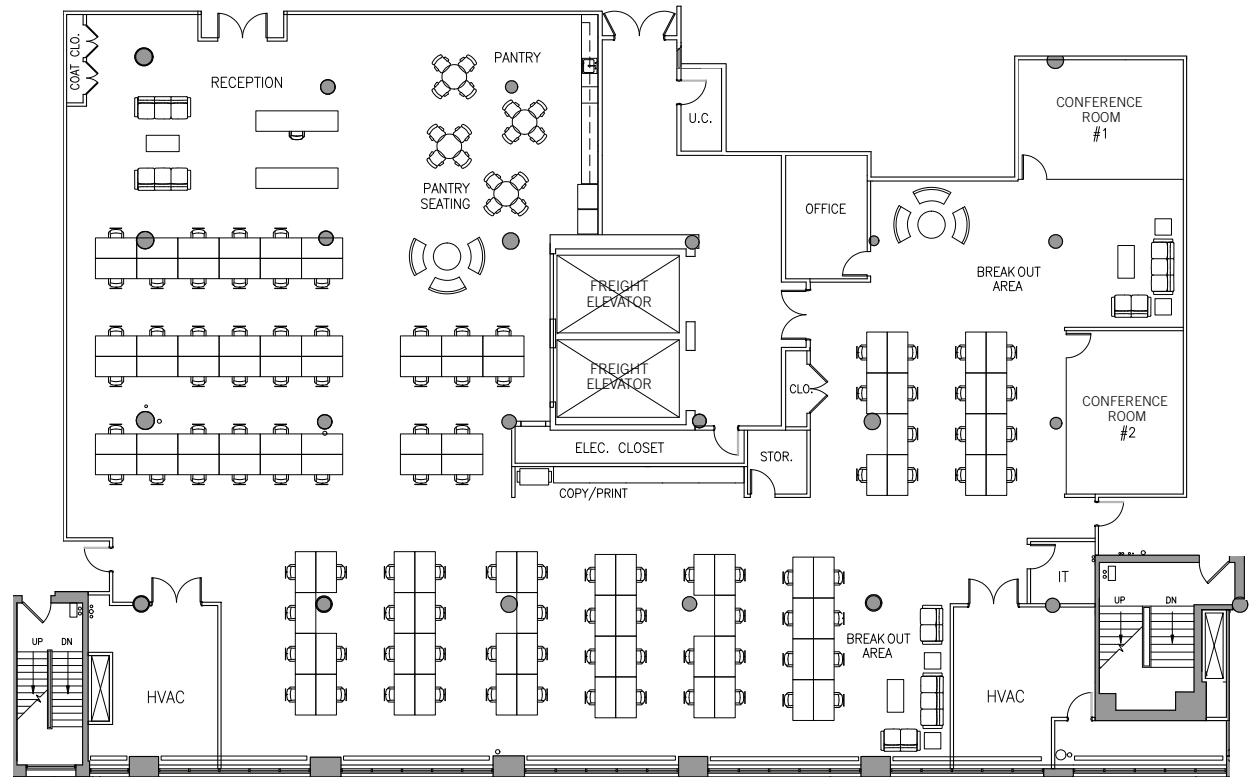

30-30 47th Avenue
Long Island City - NY, NY 11101

CONTACT:
212.372.2110

Howard J. Kessler Jr.
hkessler@ngkf.com

